

Planning Example - floor space required 215 cm x 215 cm

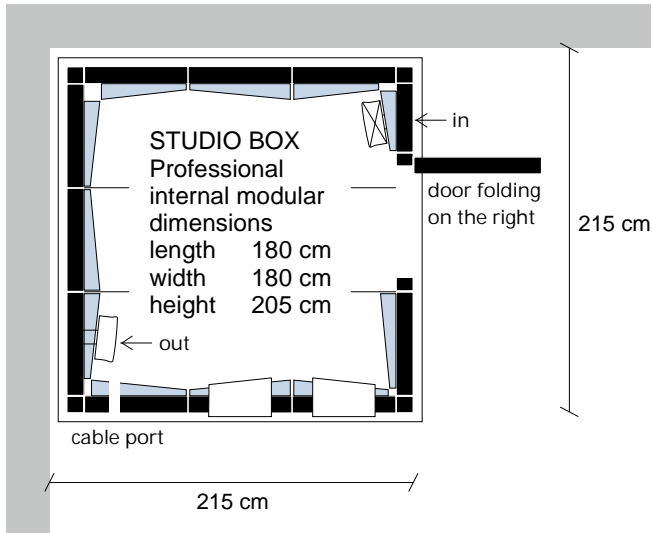

Planning Example - floor space required 215 cm x 215 cm

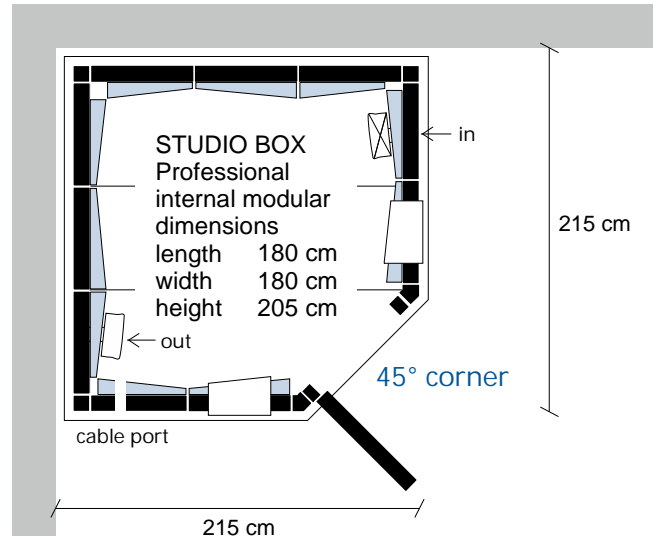

## Build your STUDIOBOX

First of all, you measure the existing room (length x width x height).

Make a simple drawing by indicating the room design, the positions and dimensions of:

- existing room (length x width x height)
- existing doors and windows
- heating pipes
- projections on the wall e.g.

## Planning Example

necessary room height for installation 240 cm,  
standard interior height 205 cm

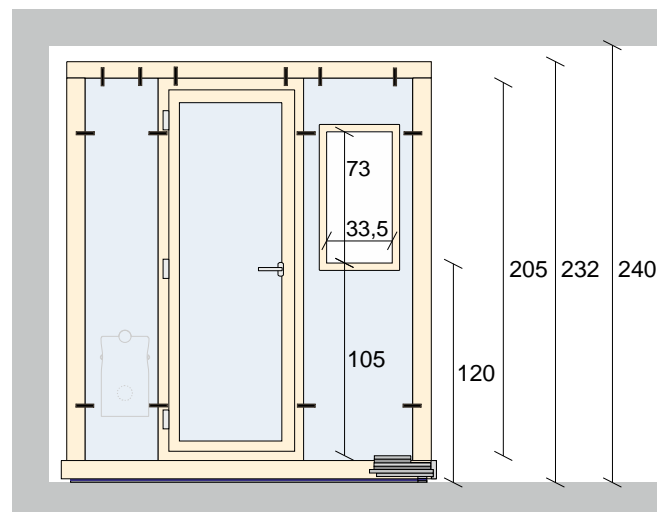

Possibly mark the desired position and approximate dimensions of the sound booth. A planning aid is on offer. Please do not forget to inform us about the application fields. Send your sketch to [info@acousticbooth-studiobox.com](mailto:info@acousticbooth-studiobox.com) or by fax +49 (0)7203-7066. We will get back to you with a customized proposal.

# STUDIO BOX

Modular Acoustic Booths

[info@acousticbooth-studiobox.com](mailto:info@acousticbooth-studiobox.com)

Fax: + 49 (0)7203 -7066

Application / Remarks:

Return to:

Studio Box GmbH  
Wilhelm-Hauff-Weg 9  
D-75045 Walzbachtal  
GERMANY

Surname: \_\_\_\_\_

Company: \_\_\_\_\_

ZIP Code & City: \_\_\_\_\_

Country: \_\_\_\_\_

Phone: \_\_\_\_\_

E-Mail: \_\_\_\_\_

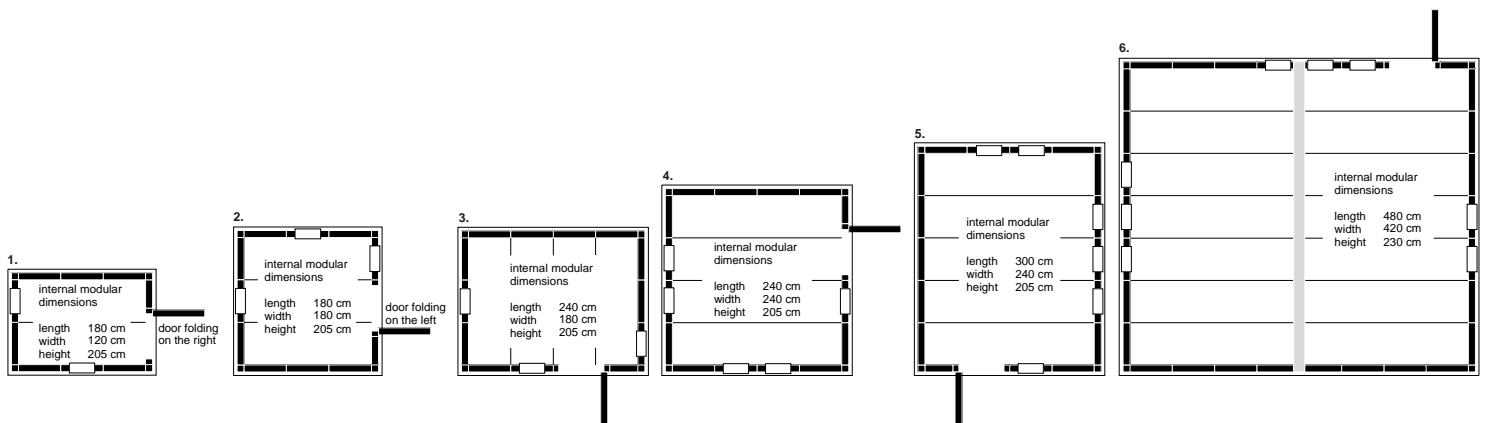

My room: